

ZENVIDA

Product name: Zenvida Floor Lamp
SKU: 275-FLRMTLCLSC01
EMAIL: priority@zenvidahome.com
TEL: 855-349-4327
<http://bit.ly/ZENVIDA>



*****WARNING*****

Power tools may strip bolts or screws. Hand tighten bolts to only about 75% tight. Do NOT completely tighten any bolt during assembly until all bolts and washers are connected. Having someone help you may make assembly easier.

Reaching out via product review, marketplace email, social media or leaving seller feedback may cause a delay in response. If you have questions about this product or need anything, please contact us. You are our priority!

Bedroom & Living Room Classic Right-angle Floor Lamp

Product Specification

Voltage :110V
Bulb Base:E26
Plug Format: US Plug
Shade Size:D12.6×H7.87 inches
Material:Fabric and metal
Item Weight:10 pounds
Style:Modern
Switch Type:Foot Pedal
Warranty:2 years

How to use

* When plugging the floor lamp in, just control the convenient pedal switch to turn on/off the light.

Precautions

- * Please check the product is in good condition before installation.
- * Please ensure the power is off before wiring and installing.
- * Please use this product for indoor only.

Easy Installation

Please as the following steps from ① to ⑧ for your reference:

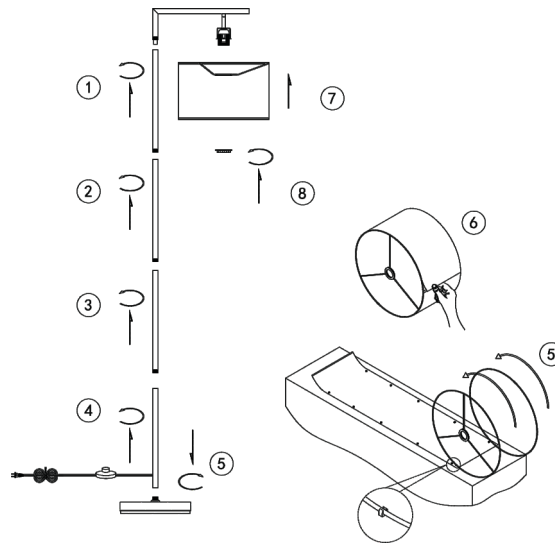

① Put the lampshade on the top.

②③④ Connect the 2nd, 3rd and 4th rods in turn.

⑤ Connect the rod with foot switch to the floor lamp base. Put the two rollers in the lampshade in the same direction, and press them into the plastic clasp to make them completely coincident. please note that the raised part of the steel ring should be inward.

⑥ Bonding velcro.

⑦⑧ Place the lamp cover at the bulb interface.